

State of New York

Sug: sa 712 mbs N. B. Birch

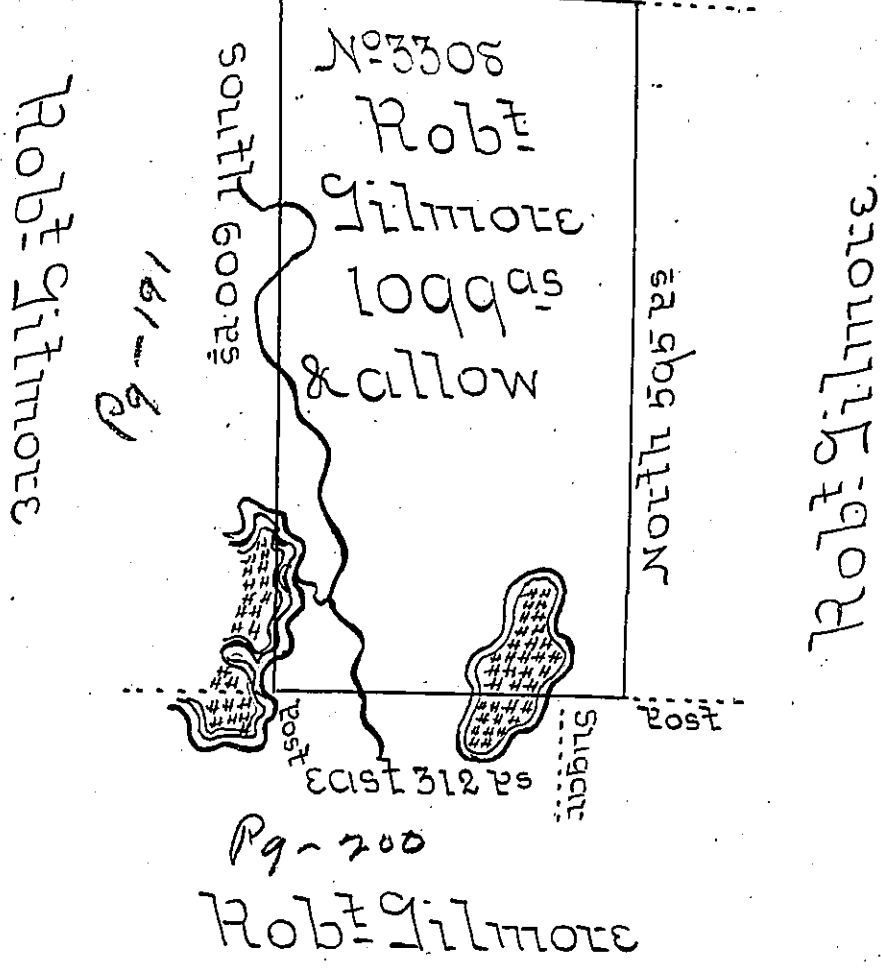

Surveyed the above described tract of land on the seventh day of the 11th mo 1793 for Robt Gilmore in pursuance of his warrant dated the 14th day of Decem^r 1792 adjoining his other land and the State of New York containing one thousand and Ninety Nine Acres and the allowance of six PE Cent -

William Ellis D.S.

Daniel Brodhead Esquire }
 Surveyor General - }

IN TESTIMONY that the above is a copy of the original remaining on file in the Department of Internal Affairs of Pennsylvania, made conformably to an Act of Assembly approved the 16th day of February, 1833, I have hereunto set my Hand and caused the Seal of said Department to be affixed at Harrisburg, this Third day of January 1906.

Joseph P. Brown
 Secretary of Internal Affairs.